

Invoice Details

Purchase Order No:	
Invoice Company Name:	
Invoice Contact name:	
Invoice Address:	
Post Code:	
Tel No:	
VAT Number:	
Email Address for invoice:	

Stand Details

Stand Type:	Shell Scheme <input type="checkbox"/> Space Only <input type="checkbox"/>
Exhibiting Company Name:	
Stand Number:	

Please supply and install the following items on hire

A 20% surcharge will apply to the below Costs if form is not received by the following date:

25/02/2022

SHELL SCHEME ADDITIONAL FITTING OPTIONS

	COST	QUANTITY	TOTAL COST
Wall Panel - 2.5m (h) x 1m (to match shell scheme)	£78.50		
Lockable Door Section 2.5m (h) x 1m To match shell scheme	£91.00		
Curtained Entrance 2.5m (h) x 1m, please specify Black or White	£71.50		
For the following items, please specify heights & locations using the page overleaf			
Flat shelf - 1m long x 300mm deep	£26.50		
Sloping shelf - 1m long x 300mm deep	£26.50		
Hat & Coat hooks fixed to wall	£28.00		
18mm MDF Infill panel, to allow for wall mounting of TV's or products. Max weight 35kg	£89.00		
Slatwall infill panel <i>Slatwall accessories available upon request</i>	£63.00		

RAISED PLATFORM FLOORS & FLOORCOVERING UPGRADES

40mm high raised platform floor, with aluminium angled edging <i>(excludes carpet, Please inform us of the reason for the platform, restrictions apply, not suitable for plumbing or air supply)</i>	£30.00		
Cord carpet colour change - to a choice from the swatch card <i>(please contact us for digital swatch card)</i>	£12.00		
Premium Floorcovering - Vinyls, Woodplank vinyl, Velour	£19.00		

REMOVAL OF FASCIA & GRID SUPPORT OPTIONS *(Requires Organiser Approval, Stands with any wall longer than 3m will require additional support)*

Support Tower 1m x 0.5m (nominal 1m x 0.5m x 2.5m high) EXCLUDES GRAPHICS	£150.00		
Support Counter (nominal 1m x 0.5m x 0.9m high) EXCLUDES GRAPHICS	£100.00		

STORE ROOMS

1m x 1m Store Room Package to Include shelf fixed to wall inside + coat hooks	£200.00		
2m x 2m Store Room Package with Angled Wall to Front, shelf fixed to wall inside + coat hooks	£250.00		
Reinforced panel (MDF) to above store Angled wall to allow for fixing of TV to wall	£100.00		

SUB TOTAL

VAT 20%

TOTAL

Goods/Services will not be provided unless fully paid for in advance. If you wish to pay by Credit/Debit Card please call +44 (0) 1264 365 550

Please note all orders are subject to availability, and stock is not reserved until full payment is made.

Cheques made payable to **Showlite Ltd**. BACS details will be available on your invoice, alternatively please contact us for details. By completing this order form, you are agreeing to our Terms and Conditions. For a copy please contact us on 01264 365550.

■ Please indicate on the below grid the position of any items ordered and any height measurements for shelves or rails

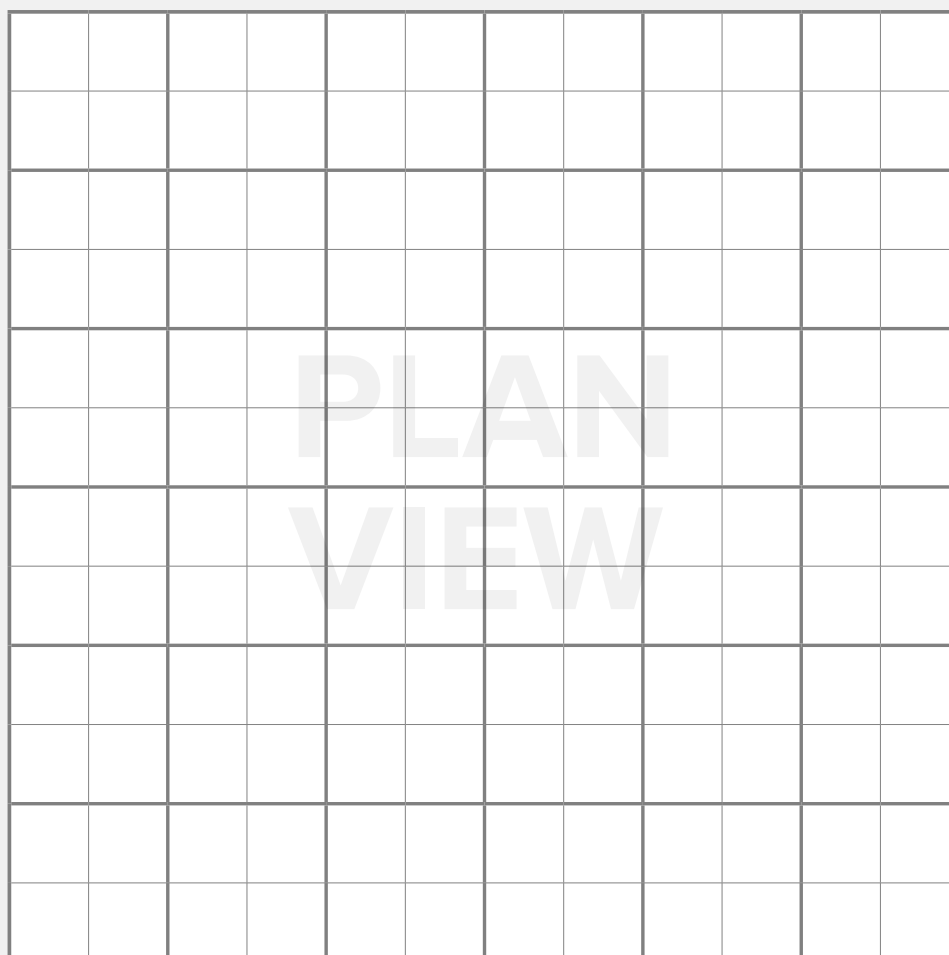

FRONT OF STAND

GRID OPTIONS

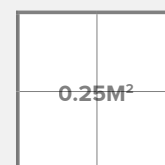

3X3 STAND

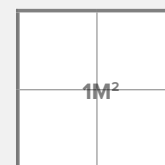

6X6 STAND

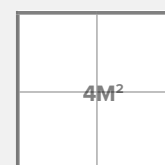

12X12 STAND

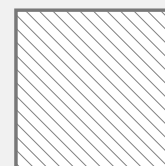

PLEASE HATCH
UNUSED SPACE

STAND NUMBER

COMPANY NAME

ADDITIONAL NOTES

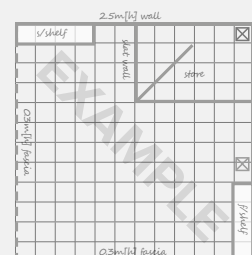

Please send your completed form to RRichards@showlite.co.uk